



3 CHOICES OF FINISH

AVAILABLE FROM STOCK

ALLOW 5 WEEKS FOR DELIVERY



Maple (ER)

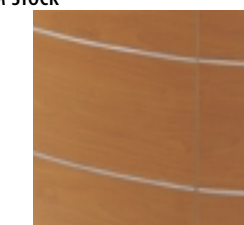

Cherry (DM)

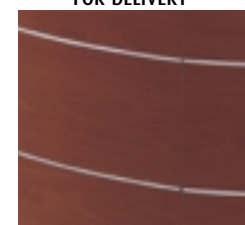

Mahogany (AJ)

Work surface and counter top

- > Total height of unit : 109 cm.
- > Height of work surface : 72 cm.
- > Usable height between glass counter top and work surface : 34 cm.
- > Work surface covered in varnished HPL laminate. Depth : 70 cm. Thickness : 3 cm. Straight edges covered by 1 mm thick wooden edge banding.
- > Counter tops made from toughened ground glass, 12 mm thick. Depth : 30 cm.

Structure

- > **Metallic legs** of tubular design in a smooth aluminium finish.
- > **Front panels** covered in HPL laminate. Thickness : 18 mm. Height : 101 cm. Metal legs in a varnished aluminium finish, complete with stabilizer feet, adjustable through 20 mm.
- > **Side panels** covered in melamine in an aluminium finish. Thickness : 20 mm. Edges covered by 2 mm thick PVC edge banding. Height : 100 cm.

Edison reception units

Edison reception units



Prices excluding VAT

When placing your order, please specify your choice of finish, see p. 149.

Solo modules

Standard module

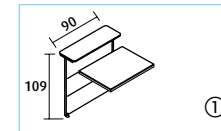

Standard module, W. 90 cm, + work surface (W x D x H cm : 90 x 70 x 72)



ED MD L + finish

£ 495

60° modules

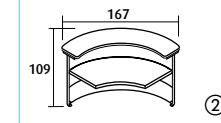

Interior 60° module + work surface (W x D x H cm : 151 x 70 x 72)



ED M60i L + finish

£ 1 075

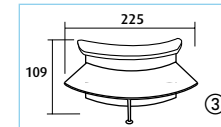

Exterior 60° module + work surface (W x D x H cm : 225 x 70 x 72)
supplied complete with single straight support leg



ED M60E L + finish

£ 1 225

90° link modules

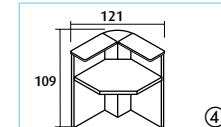

Interior 90° link module + work surface (W x D x H cm : 105 x 105 x 72)



ED M90i L + finish

£ 925

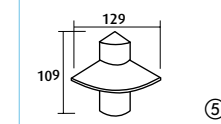

Exterior 90° link module + work surface (W x D x H cm : 70 x 70 x 72)



ED M90E L + finish

£ 295

Legs

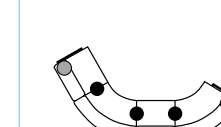

IMPORTANT

- Order one curved end leg (●) for each end of the configuration.

- Order one straight intermediate leg (●) for every point at which two work surfaces meet.

Example : in this configuration, you would need to order 2 curved end legs and 3 straight intermediate legs.

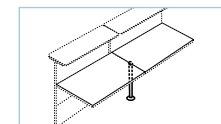

1 straight intermediate leg

ED Pi AL

£ 60

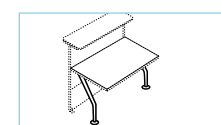

Set of 2 curved end legs

ED PE AL

£ 120

Pedestal

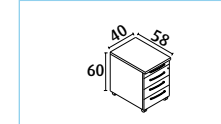

Melamine 3 drawer pedestal on castors (includes pen tray)

ED CBR3 L + finish

£ 290

Configurations

(prices include end panels and legs)

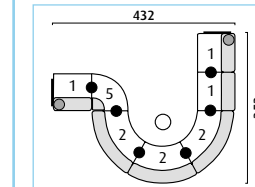

7 modules

ED C1 L + finish

£ 5 600

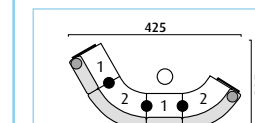

4 modules

ED C2 L + finish

£ 3 625

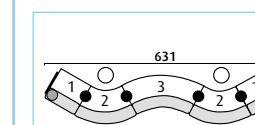

5 modules

ED C3 L + finish

£ 4 910

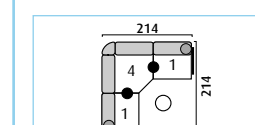

3 modules

ED C4 L + finish

£ 2 340

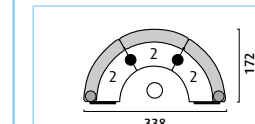

3 curved modules

ED C5 L + finish

£ 3 650

Options for standard, 60° and 90° link modules

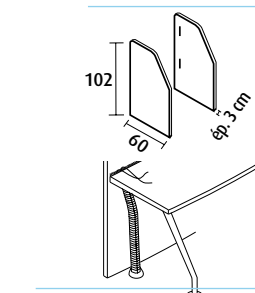

End panels
Set of 2 :

ED PL AL

£ 185

Vertebral cable holder

ED EV AL

£ 40

Complementary units



See pages 224 and 225

